

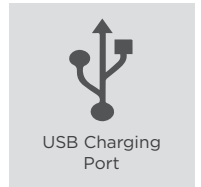

ELEGANT AND RELIABLE PFC UPS

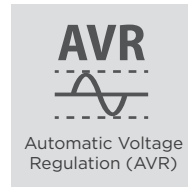
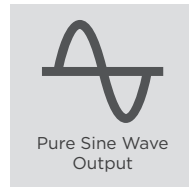
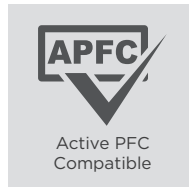
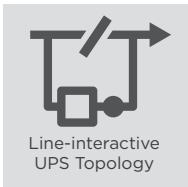

The Pure Sine Wave UPS for equipment requiring active PFC power source

Designed for home, office and back office applications, the PFC Sinewave Series adopts line-interactive topology with Automatic Voltage Regulation (AVR) function to offer stabilized Pure Sine Wave output. The products are compatible with equipment requiring active PFC power supply. Other features include RJ11/RJ45 port to provide data line protection against surge and spike, and power management software to perform PC graceful shutdown.

APPLICATION

- Home
- Office
- SOHO Office
- Back Office

SERIES FEATURES

- Line-interactive UPS Topology
- Active PFC Compatible
- Automatic Voltage Regulation (AVR)
- Phone/Fax/Modem/DSL/Network Protection
- PowerPanel® Management Software
- Energy Saving Technology
- Pure Sine Wave Output
- Surge and Spike Protection
- LCD Status Display
- USB Charging Port

PRODUCT CALLOUTS

- 1 . Power On Indicator
- 2 . Power On/Off Switch
- 3 . LCD Display Panel
- 4 . Function Button(s)
- 5 . Battery Backup & Surge Protected Outlets
- 6 . Communication Protection Ports RJ11/RJ45
- 7 . USB Charging Ports
- 8 . Input Circuit Breaker
- 9 . AC Inlet
- 10 . USB Port
- 11 . Serial Port

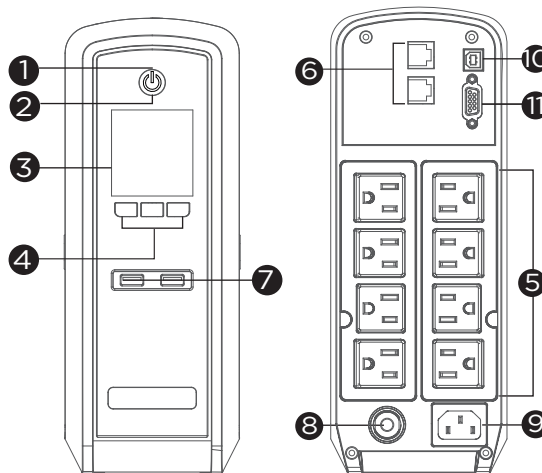

CP1300/1500EPFCLCD



TECHNICAL SPECIFICATIONS

Model Name	CP1300EPFCLCD	CP1500EPFCLCD
General		
UPS Topology	Line-interactive	Line-interactive
Energy Saving Technology	GreenPower UPS™ Bypass Technology	GreenPower UPS™ Bypass Technology
Active PFC Compatibility	Yes	Yes
Input		
Nominal Input Voltage (Vac)	230	230
Input Voltage Range (Vac)	170 - 270	170 - 270
Input Frequency (Hz)	50 ± 3, 60 ± 3	50 ± 3, 60 ± 3
Input Frequency Detection	Auto-sensing	Auto-sensing
Rated Input Current (A)	10	10
Input Connector Type	IEC C14	IEC C14
Output		
Capacity (VA)	1300	1500
Capacity (Watts)	780	900
On Battery Waveform	Pure Sine Wave	Pure Sine Wave
On Battery Voltage(s) (Vac)	230 ± 10%	230 ± 10%
On Battery Frequency (Hz)	50 ± 1%, 60 ± 1%	50 ± 1%, 60 ± 1%
Automatic Voltage Regulation (AVR)	Single Boost	Single Boost
Overload Protection	Internal Current Limiting, Circuit Breaker	Internal Current Limiting, Circuit Breaker
Outlet(s) - Total	8	8
Outlet Type	NEMA 5-15R x 8	NEMA 5-15R x 8
Outlet(s) - Battery & Surge Protected	8	8
USB Charging Port(s)	2	2
USB Charging Current (A)	2.1	2.1
Typical Transfer Time (ms)	4	4
Battery		
Runtime at Half Load (min)	9	10
Runtime at Full Load (min)	2.5	3
Typical Recharge Time (Hours)	8	8
User Replaceable	Yes	Yes
Battery Type	Sealed Lead-acid	Sealed Lead-acid
Replacement Battery Pack	RBP0124	RBP0016
RBP Quantity (pcs)	1	1
Surge Protection & Filtering		
Surge Suppression (Joules)	405	405
EMI/RFI Filtration	Yes	Yes
Phone/Network Protection RJ11/RJ45 (Combo)	1-in, 1-out	1-in, 1-out
Management & Communications		
LCD Panel	Yes	Yes
LED Indicators	Power On	Power On
HID Compliant USB Port(s)	1	1
Serial Port	Dry Contact	Dry Contact
Audible Alarms	Battery Mode, Low Battery, Overload, UPS Fault	Battery Mode, Low Battery, Overload, UPS Fault
Power Management Software	PowerPanel® Personal Edition	PowerPanel® Personal Edition
Physical		
Form Factor	Tower	Tower
Physical Size - UPS Module		
Dimensions (WxHxD) (mm.)	100 x 265 x 370	100 x 265 x 370
Weight (kg.)	10.4	11.3
Environmental		
Operating Temperature (°C)	0 - 40	0 - 40
Operating Relative Humidity (Non-condensing) (%)	0 - 95	0 - 95
Online Thermal Dissipation (BTU/hr)	41	61
Certifications		
Certifications*	CE, EAC, RCM	CE, EAC, RCM
RoHS	Yes	Yes

*Certifications may vary according to different regions. Visit www.cyberpower.com for more information.
 #All specifications are subject to change without notice.

