

UT600E/UT1000E
UT1500E/UT2200E

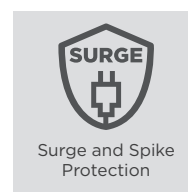

GENERATOR-COMPATIBLE TOWER UPS

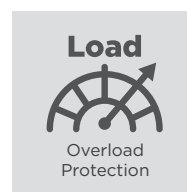
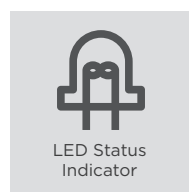
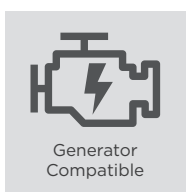
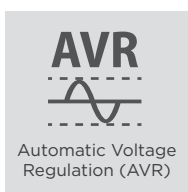
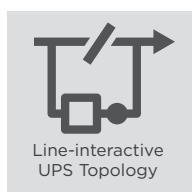

The compact UPS compatible with generators to provide power protection

Designed for home, SOHO office and office applications, the UT Series adopts line-interactive topology with Automatic Voltage Regulation (AVR) function to offer stabilized AC power output. The products are compatible with generators to extend power continuity. Other features include overload protection and configurable alarm to safeguard your devices.

APPLICATION

- Home
- Office
- SOHO Office

SERIES FEATURES

- Line-interactive UPS Topology
- Generator Compatible
- Phone/Fax/Modem/DSL/Network Protection*
- Surge and Spike Protection
- Configurable Alarm
- Tower Form Factor
- Automatic Voltage Regulation (AVR)
- LED Status Indicator
- Overload Protection
- EMI and RFI Filtration
- PowerPanel® Management Software*

*Selected Model(s)

PRODUCT CALLOUTS

1. Power On Indicator
2. Power On/Off Switch
3. Battery Capacity Indicators
4. Battery Backup & Surge Protected Outlets
5. Communication Protection Ports RJ11/RJ45

6. Input Circuit Breaker
7. AC Input Power Cord
8. USB Port

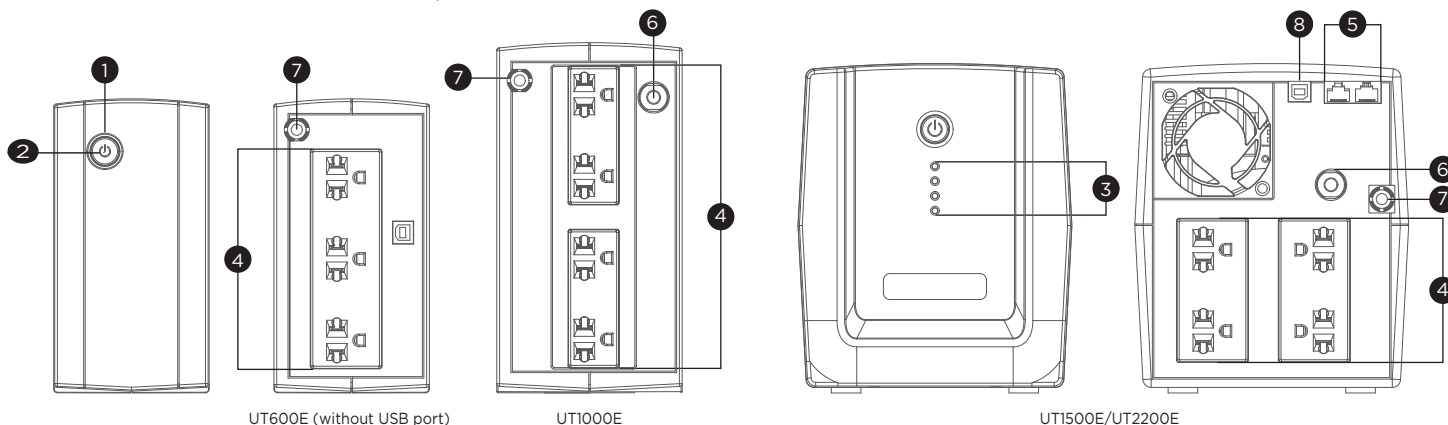

UT600E (without USB port)

UT1000E

UT1500E/UT2200E



TECHNICAL SPECIFICATIONS

Model Name	UT600E	UT1000E	UT1500E	UT2200E
General				
UPS Topology	Line-interactive	Line-interactive	Line-interactive	Line-interactive
Input				
Generator Compatibility	Yes	Yes	Yes	Yes
Nominal Input Voltage (Vac)	220 ± 10%	220 ± 10%	220 ± 10%	220 ± 10%
Input Voltage Range (Vac)	165 - 290	165 - 290	165 - 290	165 - 290
Input Frequency (Hz)	50 ± 5, 60 ± 5	50 ± 5, 60 ± 5	50 ± 5, 60 ± 5	50 ± 5, 60 ± 5
Input Frequency Detection	Auto-sensing	Auto-sensing	Auto-sensing	Auto-sensing
Rated Input Current (A)	2.72	4.55	6.82	10
Input Connector Type	NEMA 5-15P	NEMA 5-15P	NEMA 5-15P	NEMA 5-15P
Output				
Capacity (VA)	600	1000	1500	2200
Capacity (Watts)	360	600	900	1320
On Battery Waveform	Simulated Sine Wave	Simulated Sine Wave	Simulated Sine Wave	Simulated Sine Wave
Output Voltage(s) (Vac)	220 ± 10%	220 ± 10%	220 ± 10%	220 ± 10%
On Battery Frequency (Hz)	50/60 ± 1%	50/60 ± 1%	50/60 ± 1%	50/60 ± 1%
Automatic Voltage Regulation (AVR)	Single Boost, Single Buck	Single Boost, Single Buck	Single Boost, Single Buck	Single Boost, Single Buck
Overload Protection	Fuse	Circuit Breaker	Circuit Breaker	Circuit Breaker
Outlet(s) - Total	3	4	4	4
Outlet Type	AS x 3	AS x 4	AS x 4	AS x 4
Outlet(s) - Battery & Surge Protected	3	4	4	4
Typical Transfer Time (ms)	4	4	4	4
Battery				
Runtime at 60W (min)	28	65	90	95
Runtime at 90W (min)	16	43	60	70
Typical Recharge Time (Hours)	8	8	8	8
User-replaceable	No	No	No	No
Battery Type	Sealed Lead-acid	Sealed Lead-acid	Sealed Lead-acid	Sealed Lead-acid
Surge Protection & Filtering				
Surge Suppression (Joules)	125	125	125	125
EMI/RFI Filtration	Yes	Yes	Yes	Yes
Phone/Network Protection RJ11/RJ45 (Combo)	-	-	1-in, 1-out	1-in, 1-out
Management & Communications				
LED Indicators	Power On, Line Mode, Battery Mode, Low Battery		Power On, Line Mode, Battery Mode, Battery Capacity, Low Battery	
HID Compliant USB Port(s)	-	-	1	1
Audible Alarms	Battery Mode, Low Battery, Overload, UPS Fault			
Power Management Software	-	-	PowerPanel® Personal Edition	
Physical				
Form Factor	Tower	Tower	Tower	Tower
Physical Size - UPS Module				
Dimensions (WxHxD) (mm.)	84 x 159 x 252	100 x 189 x 325	148 x 178 x 298	148 x 178 x 298
Weight (kg.)	3.6	6.7	9.1	10.8
Environmental				
Operating Temperature (°C)	0 - 40	0 - 40	0 - 40	0 - 40
Operating Relative Humidity (Non-condensing) (%)	0 - 90	0 - 90	0 - 90	0 - 90
Online Thermal Dissipation (BTU/hr)	40	45	102	170
Certifications				
RoHS	Yes	Yes	Yes	Yes

#All specifications are subject to change without notice.